11.2 Future use of the bocce courts in Hardy Gallagher Reserve

Trim Record Number: D18/87083

Responsible Officer: Director Planning and Place Making

[Help](#)

Purpose

1. To update Council on the results of the community consultation undertaken to determine the future use of the bocce courts in Hardy Gallagher Reserve and to seek direction on a way forward.

Background

2. In December 2016, Council received a proposal from the North Carlton Railway Neighbourhood House Committee of Management regarding possible improvements to the space currently occupied by the bocce courts in Hardy Gallagher Reserve. Ideas presented included a neighbourhood garden, sitting area, area for young children and retention of a lane for bocce.



3. After receiving submissions on this topic as part of the 2017/18 budgetary process, officers committed to a community consultation on future use of the Bocce Courts at Hardy Gallagher Reserve.
4. Pending the outcome of the consultation and subject to Council's support for the inclusion of the bocce court in the North Carlton Neighbourhood House lease area, Council could provide \$10,000 from within existing resources, as a one off payment, to the North Carlton Neighbourhood House to fund planning and design for the space.
5. In line with this advice, Council officers commenced consultation on the future use of the bocce courts at Hardy Gallagher Reserve in February 2018.

External Consultation

6. Community consultation on the future use of the bocce courts at Hardy Gallagher ran from 26 February – 29 March 2018.
7. Consultation methods to inform the wider community and visitors of the online forum and drop in session included:
 - (a) postcard mail out to 1500 local residents, advising that Council was in the early stages of thinking about how the bocce courts could be used to better support the community in the future, and residents were asked what three words best described their vision for the space (refer Attachment 1);
 - (b) signs on site in Hardy Gallagher Reserve;
 - (c) social media campaign via Facebook and Twitter (seen by 18,179 users across those platforms);
 - (d) article in Yarra Life online newsletter (accessed by 306 users); and
 - (e) community drop in session at the North Carlton Railway Neighbourhood House held on Saturday 17 March 2:00pm-4:00pm (attended by 63 community members).
8. Key stakeholders were sent a letter informing them of the project and consultation process. They were advised that a stakeholder meeting would be held on Thursday 19 April (6.30-7.30pm) at the North Carlton Railway Neighbourhood House, to review and discuss the feedback and the next steps in the process.

Consultation results

9. Below is a summary of the number of participants that engaged during the community consultation and engagement period.

Method	Participants
Your Say Yarra	111
Email	12 submissions
In person at on site consultation	63 attendees

Online consultation

10. The Your Say Yarra webpage generated 1,200 unique visitors and 111 ideas were submitted and voted on by 159 visitors. The most popular ideas (including a breakdown of the top 10) are presented as Attachment 2.
11. Overall results showed strong support for the future vision of the bocce courts to encompass “community” and “garden”.

Community drop-in session

12. The drop-in session was facilitated by an independent facilitator, and was attended by 63 people. The purpose of this event was to invite people down to enjoy the park and stimulate discussion on the space.
13. As part of the session, people were encouraged to provide feedback on the future of the bocce courts via a “dotmocracy” on the feedback boards.
14. Five key questions were placed on a wall and around each question were some of the words and ideas that had been suggested as part of the on-line consultation process. Participants were then provided with five green dots and two red dots and asked to place their green dots on ideas they supported and their red dots on ideas that they had concerns about. If they had an idea that wasn’t already captured on the wall, they could add a new idea. Results are presented as Attachment 3.

15. Overall, the feedback received during the workshop was consistent with the feedback received online, with the majority of people voting for a shared growing space that could be used by everyone.

Written Submissions

16. Twelve written submissions were received during the consultation period. Of these, five supported a shared growing space, four opposed this idea and three suggested other uses (Attachment 4).
17. A further five written submissions were received outside the formal consultation process. Four of these did not support gardening activities at this location. The fifth provided feedback on park specific installations, not material to this process.

Community Stakeholder Consultation

18. Following the broader engagement process, representatives from stakeholder groups were invited to participate in a meeting to discuss the feedback and the next steps in the process. Officers approached the following stakeholder groups:

- (a) Princes Hill Primary School;
- (b) Princes Hill Secondary College;
- (c) Redmond Park Retirement Apartments;
- (d) Princes Hill Community Centre;
- (e) the North Carlton Railway Neighbourhood House Committee of Management;
- (f) Manager, North Carlton Railway Neighbourhood House; and
- (g) Friends of Hardy Gallagher Reserve.

19. The meeting was attended by representatives of:

- (a) The North Carlton Railway Neighbourhood House Committee of Management;
- (b) Redmond Park Retirement Apartments;
- (c) Princes Hill Community Centre; and
- (d) Friends of Hardy Gallagher Reserve.

20. The format of the meeting was to:

- (a) recap on the main topics to emerge from the consultation;
- (b) look at the key things to consider for each of these topics; and
- (c) discuss potential solutions/ideas.

21. The idea of a shared growing space was generally advocated for by representatives of the North Carlton Railway Neighbourhood House Committee of Management, Redmond Park Retirement Apartments and Princes Hill Community Centre. Representatives of the Friends of Hardy Gallagher Reserve expressed concern at the use of public open space by a select few and it was argued the land should be returned to parkland where it would be accessible to all.

22. Some stakeholders felt that the bocce courts were no longer used and should be removed, while others felt they were an important part of the sites heritage and regular maintenance would encourage use. A summary of the key comments from this meeting is included in Attachment 5.

Local value of bocce courts

23. In terms of the heritage value of the bocce courts as expressed by residents, one written submission identified the bocce courts as having an important link to the Italian cultural heritage of the area.

24. The bocce courts at Hardy Gallagher have not been well used since the Montemurro Bocce Club ceased to exist approximately eight years ago. In terms of the overall feedback received, there was relatively little interest from the current community to retain the courts. In addition, there are two existing bocce lanes at Edinburgh Gardens which are not well used.
25. The following recommendations from the Conservation Management Plan and Master Plan make specific reference to the bocce courts:

Inner Circle Railway Linear Park Reserve Conservation Management Plan, January 2005

Description:

The Bocce court is located on the former North Carlton Station's eastern side. It comprises a series of sand beds enclosed by timber sleepers.

Significance:

The Bocce court is an intrusive element and is of no heritage significance.

Policy:

The Bocce court obscures the original track route and should be relocated.

(See Chapter 5, 5.2.4)

Inner Circle Railway Linear Park Reserve Conservation Master Plan, November 2006

Bocce Courts:

To be retained to the end of their useful life period as recommended by CMP.

Internal Consultation (One Yarra)

26. Internal consultation was undertaken with the following Council Units:
 - (a) Community Partnerships;
 - (b) Waste Minimisation and Agriculture;
 - (c) Communications and Engagement; and
 - (d) Open Space Maintenance.

Financial Implications

27. After receiving submissions on this topic as part of the 2017/18 budgetary process, officers committed to a community consultation on future use of the Bocce Courts at Hardy Gallagher Reserve.
28. Pending the outcome of the consultation and subject to Council's support for the inclusion of the bocce court in the North Carlton Neighbourhood House lease area, Council could provide \$10,000 from within existing resources, as a one off payment, to the North Carlton Neighbourhood House to fund planning and design for the space.

Economic Implications

29. There are no economic implications associated with this report.

Sustainability Implications

30. The inclusion of a food growing space would contribute local solutions to food sustainability. Benefits could include: collaborative consumption; waste reduction; compost; production; reduction of the heat island effect; and air quality improvement.
31. Food growing spaces require a constant source of water and are subject to water use restrictions as for residential properties. Where appropriate, water could be harvested from the North Carlton Railway Neighbourhood House, however water from mains supply would still be required.

Social Implications

32. The consultation process revealed strong support for the future vision of the bocce courts to be a space for “community” and “garden”, such as a food growing space. Social benefits including health; environmental education; connection; amenity and diversity.
33. If the North Carlton Railway Neighbourhood House were to oversee the food growing space, then there is opportunity develop programs which further develop community building.
34. The bocce courts have an important link to the Italian cultural heritage of the area.

Human Rights Implications

35. There are no human rights implications associated with this report.

Communications with CALD Communities Implications

36. Consultation material included a translation panel containing advisory text in eight languages: Vietnamese, Greek, Mandarin, Cantonese, Italian, Turkish, Arabic and Spanish.

Council Plan, Strategy and Policy Implications

37. The following is included in the 2017-21 Council Plan:

Objective	Strategies	Strategic Indicators	Initiatives
3. A Sustainable Yarra	3.6 Promote and facilitate urban agriculture with a focus on increasing scale and uptake in the community	Increase the number of urban agriculture community initiatives supported and promoted	3.6.1 Showcase urban agriculture and support community initiatives in sustainable practices

Legal Implications

38. The relevant land is Crown land temporarily reserved for public recreation purposes under the control of City of Yarra as Committee of Management.
39. Any change to the approved purpose would require Ministerial/Parliamentary approval. Such approval can take 4-6 months.
40. Approval would also be required from the Department of Environment, Land, Water and Planning (DELWP) to ensure that the proposed lease purpose is not detrimental to the purpose of the reserve.
41. The bocce courts are zoned as Public Park and Recreation (PPRZ) in the Yarra Planning Scheme with a Heritage Overlay (HO329) affecting the site.
42. Under the zone, a change of use to a community garden would be an as-of-right use and therefore would not require a planning permit for the use (car parking considerations is to the satisfaction of Council).
43. A planning permit may be required for buildings and works, under the Heritage Overlay controls.

Other Issues

Fence

44. There are currently two fences around the bocce courts at Hardy Gallagher Reserve, the outer fence is a 1.2m high chain link fence, and the inner fence is a timber post and rail fence. The existing outer fence is in reasonable condition, while the timber post and rail fence has some missing sections.
45. In terms of the feedback received during the consultation period, feedback on the fence was varied:
 - (a) In the online feedback, there were only a few comments made in relation to the fence, both for and against;

- (b) At the community drop in session, the idea 'retain bocce and remove fence' received six red dots and five green dots. The idea of 'no fence' received two green dots;
- (c) Three of the written submissions suggested that the fence should be removed; and
- (d) It is understood that proponents of the shared growing area are supportive of the fence being retained.

46. Due to the planning controls in place, demolition of the fence would require a planning permit.

Shared growing space – ongoing management considerations

47. The North Carlton Railway Neighbourhood House Committee of Management has submitted a brief proposal regarding the establishment and ongoing management of a shared gardening space on the existing bocce courts.
48. There is no current formal relationship between the Neighbourhood House and the Bocce courts. There was a formal arrangement between the House and the Bocce Club until the Bocce Club ceased as an entity several years ago. Since that time the Bocce courts have been hired out via the House with no formal arrangement. The lease between the House and Council does not include the Bocce courts.
49. Shared gardening spaces need resources over the long term. It is recommended that further detail be sought on the proposed ongoing daily management of a growing space to ensure that it would meet the health, safety and amenity requirements of the surrounding community. This is particularly important, given the sites highly visible location within much valued parkland and could be addressed as part of the Licence agreement with the neighbourhood house.

Physical improvements and ongoing maintenance

50. If Council supported a change of use, it is likely that there would be strong interest from the community on any proposed changes to the bocce courts.
51. Should Council support shared gardening at this space, Council could require the Neighbourhood House to exhibit their planned alterations for community feedback. Final approval for any improvements at this site would be subject to officer approval as part of the conditions of the Licence.
52. Council typically enters into Lease and Licence agreements with clear roles and responsibilities with regards to ongoing maintenance. As with any formal agreement, failure to comply with the conditions of use could result in the Lease or Licence being revoked.

Options

53. Having considered the outcomes of the initial community consultation, there are four options for consideration by Council.

Option 1 – Convert the bocce courts into a shared gardening space

Officer Comments

54. Pros

- (a) This use responds to the most popular ideas for the future use of the site, which were "garden", "community", "food", "space" and "green";
- (b) A shared growing space in this location could increase the use of the existing space and would be open for all to use;
- (c) A shared growing space would provide opportunities for social connection and engagement with nature;
- (d) A shared growing space could be used to enhance the community building programs run by the North Carlton Railway Neighbourhood House; and

- (e) Initial discussions with representatives of the Neighbourhood House Committee of Management have indicated a willingness on their part to manage this site for gardening purposes.

55. Cons

- (a) Use as a shared growing space may only appeal to a small number of interested people and therefore limits public use of the land;
- (b) There would need to be an ongoing commitment from the proponents of the garden to establish and maintain the space to an agreed standard;
- (c) The issue of future management and maintenance is still to be resolved and the cost of establishment and ongoing maintenance of the site is not known; and
- (d) Removal of the bocce courts does not acknowledge the historic use of the site for casual games.

Option 2 – Convert the bocce courts into a shared gardening space but retain one bocce lane

Officer Comments

56. Pros

- (a) The retention of a bocce lane would enable continued use of the facility by bocce users, which was in the top 10 most liked suggestions put forward during the online consultation;
- (b) Bocce reflects the heritage of the local area;
- (c) Keeping one lane open would allow sufficient space for a shared gardening space and associated social activities;
- (d) A shared growing space and one bocce lane would provide opportunities for social connection and engagement with nature; and
- (e) Initial discussions with representatives of the Neighbourhood House Committee of Management have indicated a willingness on their part to manage this site for gardening purposes.

57. Cons

- (a) The conversion of the space for shared gardening and bocce may only appeal to a small number of interested people and therefore does not increase public use of the land;
- (b) There would need to be an ongoing commitment from the proponents of the garden to establish and maintain the space to an agreed standard; and
- (c) The issue of future management and maintenance is still to be resolved and the cost of establishment and ongoing maintenance of the site is not known.

Option 3 – Retain bocce courts as they are

Officer Comments

58. Pros

- (a) The retention of the bocce courts would enable continued use of the facility by bocce users and the general community;
- (b) Bocce scored within the top 10 most liked ideas for the future use of the space; and
- (c) Retaining the bocce courts reflects the heritage of the local area.

59. Cons

- (a) The bocce courts are currently underutilised;

- (b) There are other bocce courts available at Edinburgh Gardens which are also under-utilised; and
- (c) Retention of the bocce courts in their current form does not respond to the local community's future vision for the space, which was for a use that promoted "garden" and "community".

Option 4 – Remove bocce courts and return to parkland.

Officer Comments

60. Pros

- (a) Access to public open space would be increased; and
- (b) Removal of the fence and bocce courts could provide further opportunities for natural plantings and therefore improved habitat values.

61. Cons

- (a) There would be limited opportunity for locals to actively connect and socialise; and

62. There is already considerable accessible (non-programmed) open space in the area.

Conclusion

- 63. The outcome of the consultation showed strong support among the local community for the bocce courts to be converted into a shared growing space and be open to everyone.
- 64. The current bocce courts have been seeing declining usage over the years.
- 65. A number of submissions received referenced the historical significance of the bocce courts to the area, with some expressing a desire to continue to be able to use the courts for casual games.
- 66. There was concern among some in the community that converting the bocce courts into a shared growing space would result in the appropriation of public space for the exclusive use of a small group of users.
- 67. It is considered that the conversion of the court area for a shared growing space and the retention of a lane for bocce present an option that satisfies the majority future vision of those who participated in the consultation.
- 68. Retaining more than one bocce lanes would impact upon the function of a potential community growing space. If more courts were retained, it would be possible to do some on the remaining space; however it would limit the design in relation to community outcomes such as seating and play features.
- 69. Initial discussions with representatives of the Neighbourhood House Committee of Management have indicated a willingness on their part to manage this site for gardening purposes.
- 70. Detailed design of the shared growing space (including species selection) would need to be carefully considered to realise the vision of the broader community. A robust governance model would also need to be implemented to ensure the space is managed and maintained to a high standard.

RECOMMENDATION

1. That Council:
 - (a) notes the feedback received during the consultation period and thanks the community for its contribution on this topic;
 - (b) notes that the conversion of the court area for a shared growing space and the retention of one (1) lane for bocce presents an option that satisfies the majority future vision of those who participated in the consultation;
 - (c) authorises officers to commence the process of preparing a licence agreement over the site currently defined by the bocce courts plus the garden bed immediately south of the existing fence line (consistent with the plan in Attachment 6) to the North Carlton Railway Neighbourhood House to improve the site and manage the site for gardening purposes on behalf of the community;
 - (d) notes that designs showing future improvements shall include retention of one (1) lane of the bocce courts for play;
 - (e) notes that process of entering into a licence agreement is subject to a standard process and requires approval from the Department of Environment, Land, Water and Planning; and
 - (f) requires that the draft design shall be exhibited on site for a period of no less than two weeks prior to being approved by officers as part of the process for preparing a licence agreement.

CONTACT OFFICER: Justin Hanrahan
TITLE: Manager Open Space and Recreation
TEL: 9205 5720

Attachments

- 1 Postcard flyer
- 2 Summary of online feedback
- 3 Results of community drop in session
- 4 Written submissions
- 5 Summary of stakeholder workshop
- 6 Proposed licence area

YOUR SAY
YARRA



Hardy Gallagher Reserve

Share your future vision for the bocce court area of Hardy Gallagher Reserve.

Visit yarracity.vic.gov.au/HGR or come to our **community workshop on Saturday 17 March 2018** (turn over for details).



The bocce courts next to the North Carlton Railway Neighbourhood House in Hardy Gallagher Reserve are no longer in regular use.

We're now in the early stages of thinking about how this land could be used to better support the community in the future.

What three words best describe your vision for this space?

Your three words could tell us about the atmosphere and landscape you would like to see in the space, the kinds of communities it could attract, the active and passive uses it could foster, or anything else you wish to share.

Submit your three words by Thursday 29 March 2018.

HAVE YOUR SAY

Online

www.yarracity.vic.gov.au/HGR

In Person

Community workshop from 2pm to 4pm on Saturday 17 March 2018 at Hardy Gallagher Reserve.

MORE INFORMATION

Phone

Open Space team on 9205 5555

Email

info@yarracity.vic.gov.au

(subject line: Hardy Gallagher Reserve)

For information in your language, please call 9280 1940 and quote the REF number below. | 欲知粵語版本的資訊，請致電9280 1932並報上下列REF號碼。 | Για πληροφορίες στα Ελληνικά, παρακαλούμε καλέστε το 9280 1934 και αναφέρετε τον αριθμό REF παρακάτω. | Per informazioni in italiano siete pregati di chiamare il numero 9280 1931 e di citare il numero di riferimento (REF number) sottoindicato. | 欲知普通话版本的信息，请致电9280 1937并报上下列REF号码。 | Para información en castellano, llame al 9280 1935 y cite el número de REF. De más adelante. | Để biết thông tin bằng tiếng Việt, xin hãy gọi số 9280 1939 và nói số REF dưới đây. | للمعلومات باللغة العربية، يرجى الاتصال هاتفياً بالرقم 9280 1930 والإشارة إلى رقم المرجع REF المذكور أدناه. REF 18021

Attachment 2: Summary online feedback

Top 10 responses receiving most likes

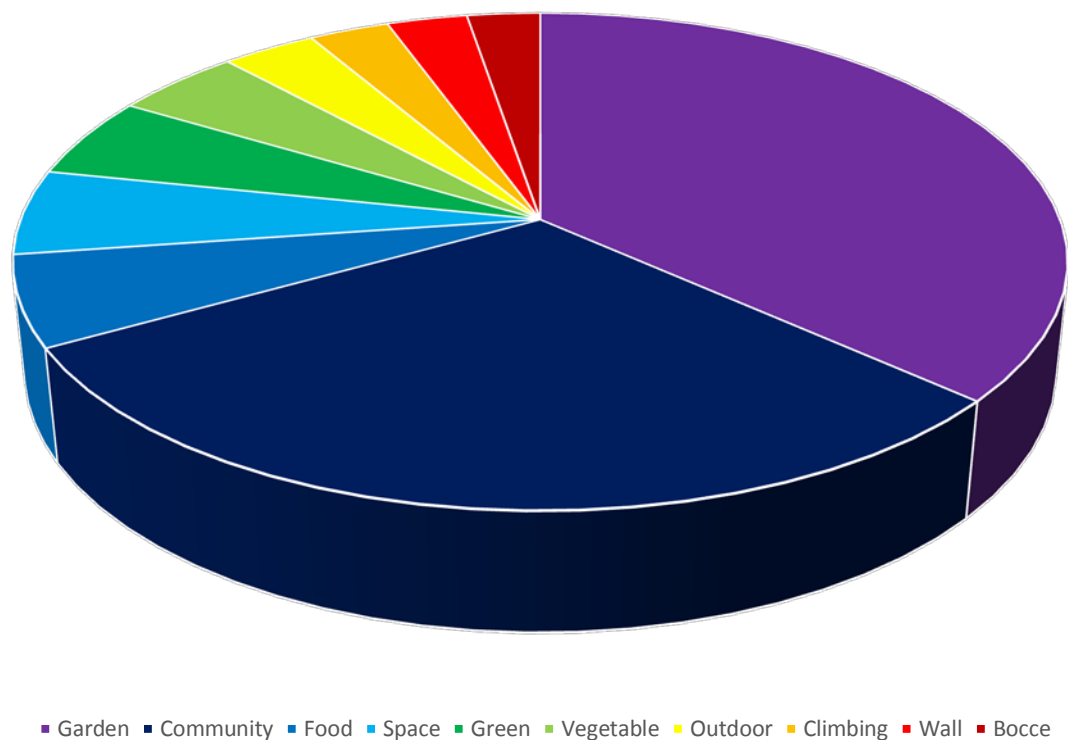

Most commonly used words (visualisation)



Online feedback summary - raw numbers for words that received double-digit responses

Word	uses + votes
Garden	430
Community	355
Food	69
Space	65
green	62
Vegetable	54
Outdoor	40
Climbing	34
Wall	34
Bocce	31
Share	31
Open	29
Free	26
beautiful	22
children	22
Collaborative	22
multipurpose	19
New	19
Petanque	18
plots	17
Thriving	16
Public	14
Land	13
nature	13
play	13
volunteer	13
Arts	12
Coffee	12
forest	12
lush	12
Sovereign	12
Treaty	12
Wurundjeri	12
shelter	11
Trees	10

Attachment 3: Results of community drop in session

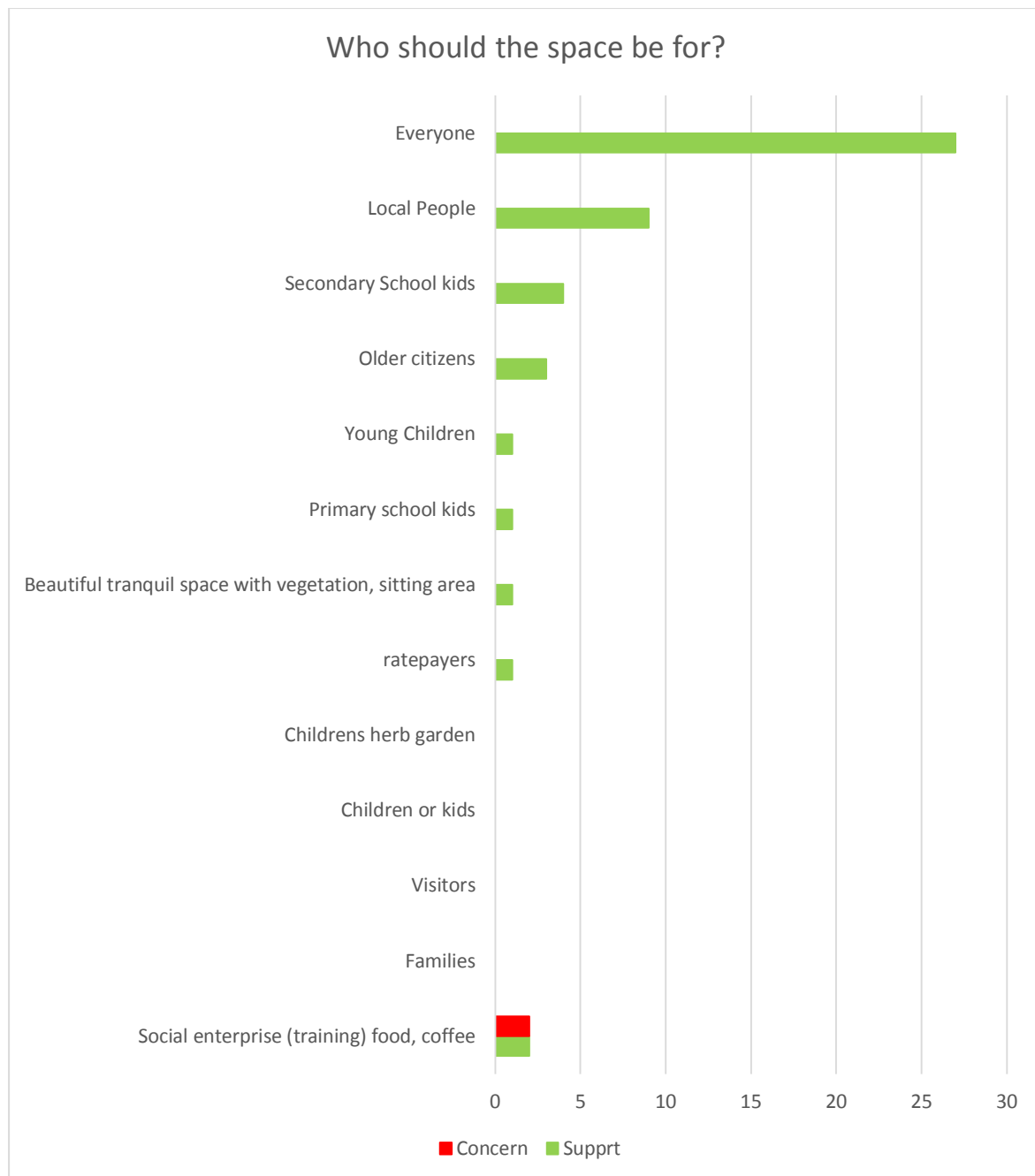

What would you like to do there?

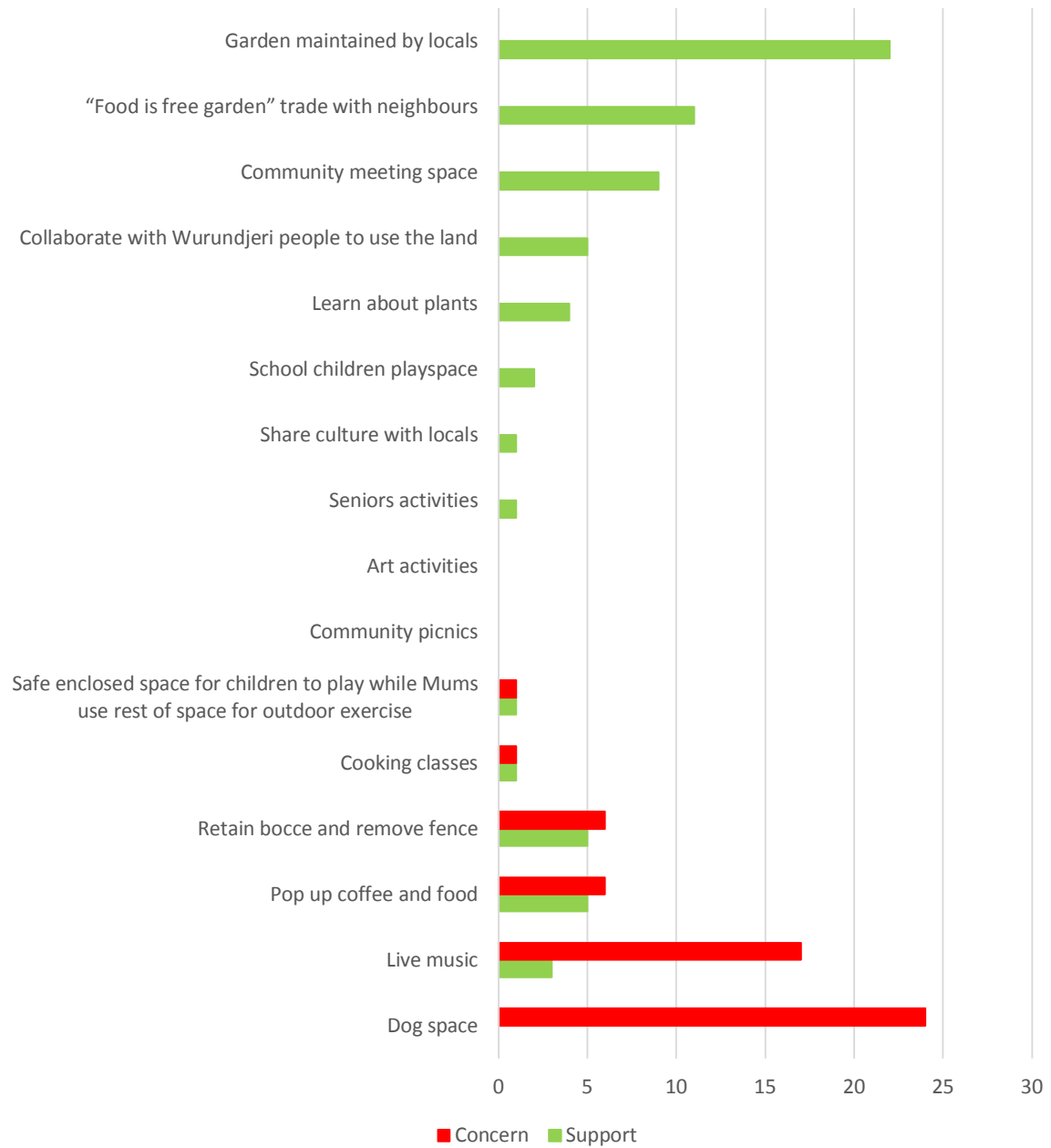

What should be installed?

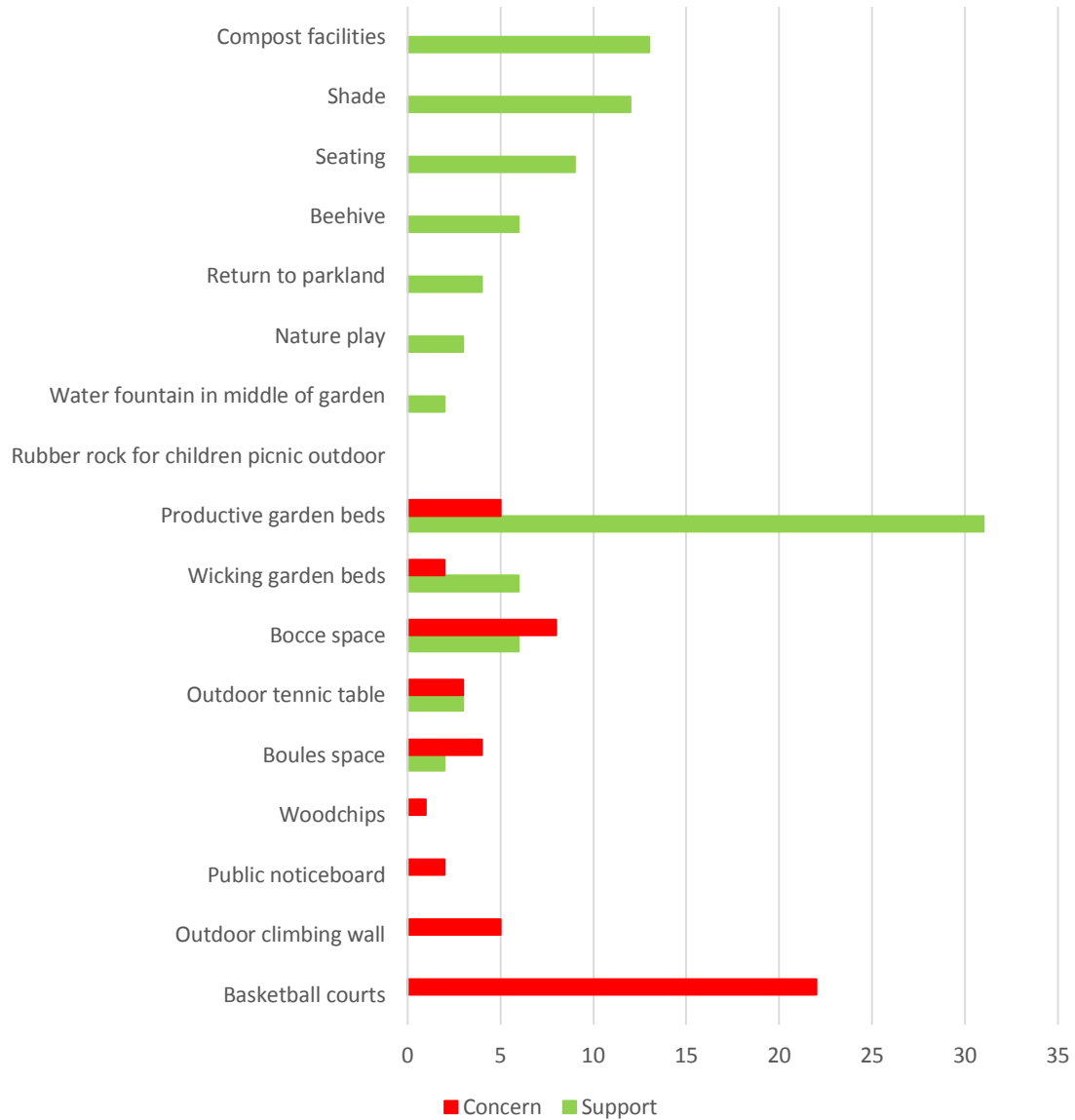

What sort of Vegetation?

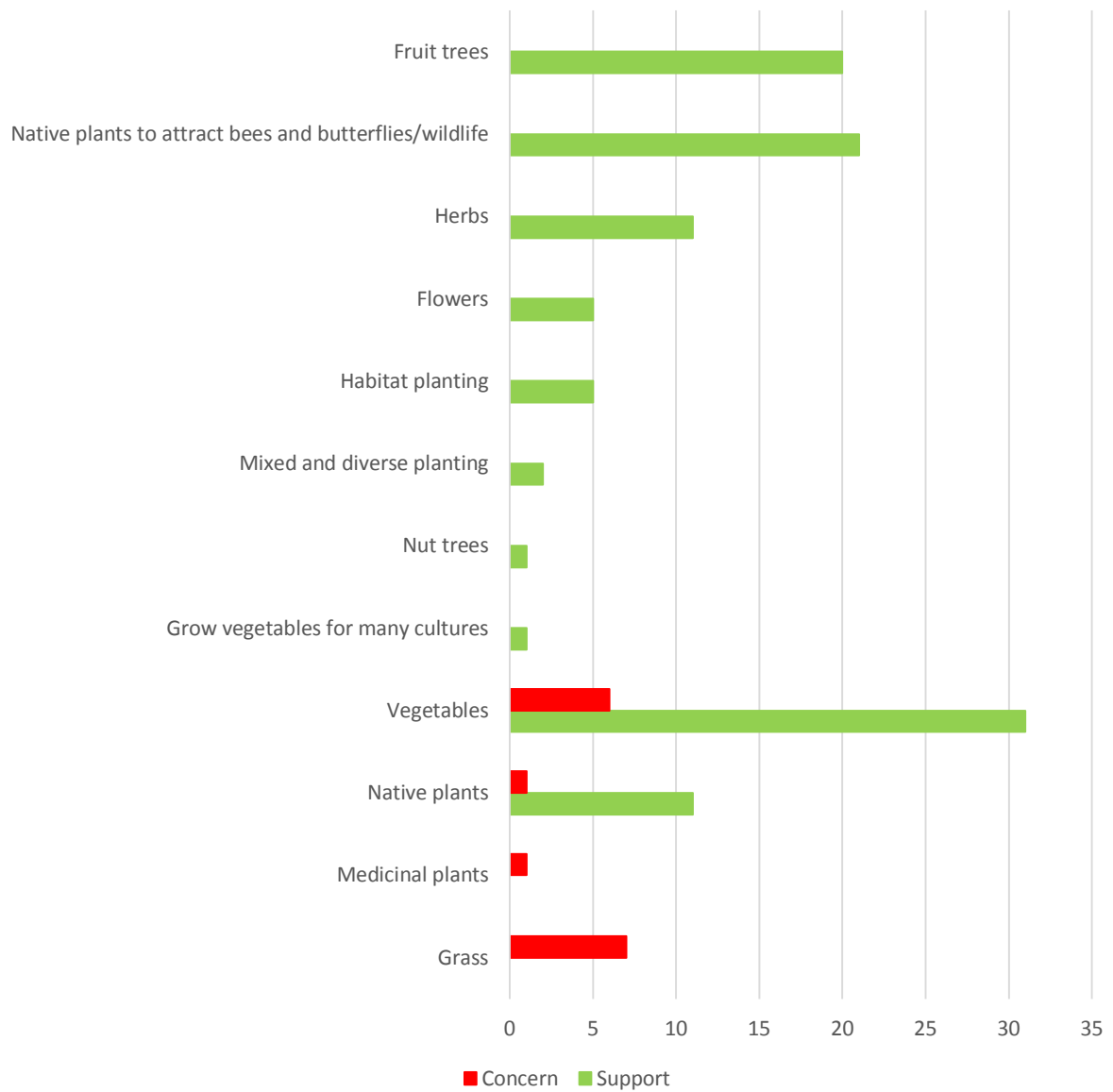

What else?

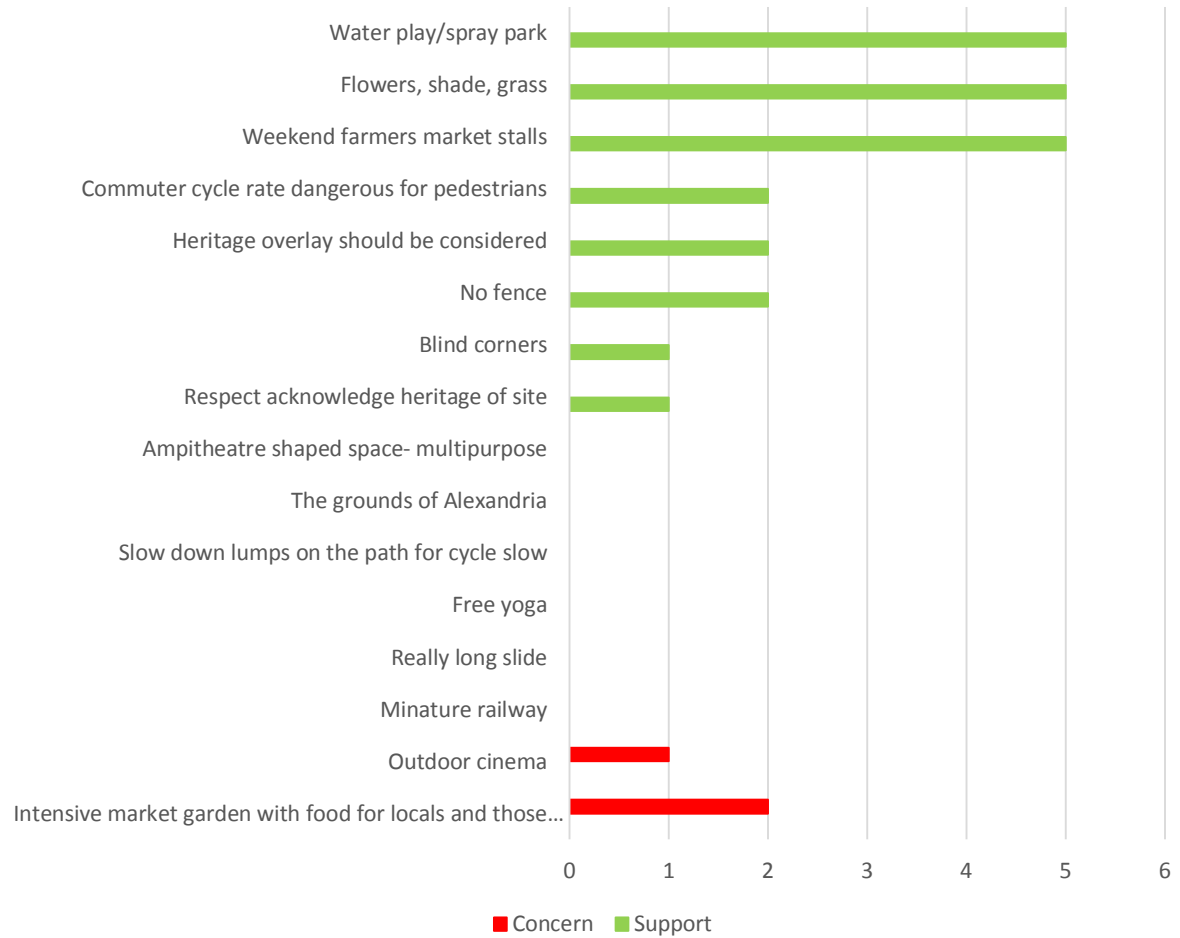

Attachment 4: Written submissions

From: [REDACTED]
To: [City of Yarra Info](#)
Subject: Hardy Gallagher Reserve
Date: Thursday, 15 March 2018 10:14:48 AM

Dear Open Space Team

Re: The Hardy-Gallagher Park

We live on Park St, directly opposite the Bocce Courts. We have one major concern: that any planned change to the area should incorporate a SAFE cycle-path intersection on the north-east corner. At the moment the bushy growth around the Bocce Courts makes it a blind intersection from two directions, and there are frequent near-misses between pedestrians and cyclists coming north from the primary school (from Wilson Street) and commuting cyclists travelling east on the Capital City Trail. With the recent rapid increase in bike traffic unlikely to abate, the existing intersection is a serious accident waiting to happen, probably involving a small child colliding with an adult pedalling fast on a bike travelling east-west.

If the Team is unconvinced about the importance of this bike crossing, it may be worthwhile to study the bike traffic at this point; it goes in multiple directions, with heavy traffic coming and going erratically along and across Park St itself because of the laneway from Brunswick Rd through to Park St. The traffic at peak morning and evening times is easily commensurate with that counted at the Nicholson-st/Park St intersection, and adding any kind of 'community garden' on that corner would increase the traffic chaos and the consequent risk of accidents.

We believe it is in the best interests of the community as a whole if the courts are returned to open parkland. If there is to be a 'community garden' of some kind it should be open and unfenced. **MOST IMPORTANTLY** the cycle path intersection should be rendered safe. There should be **NOTHING** restricting the view of either pedestrians or cyclists in any direction at this intersection.

[REDACTED]

Re-development of the
Bocce Courts- Adjoining
Gallagher Reserve Princes Hill.



Princes Hill Restorative garden

The Past

- North Carlton/Princes Hill has seen numerous community groups living within and carrying out their lives over the past 100 years. Originally housing working class immigrants from the British isles.
- In the 60's the settlement of Greek and Italian communities began and with them the concept of home gardening.
- New migrant families at the time grew traditional varieties of horticultural and tree crops.
- These varieties were grown as they had a cultural significance to these groups E.G Roma tomato for sauce making and grape vines for wine.
- The Bocce courts of Princes Hill would most likely have been a place for some community members to meet and share the products(and seeds) of Princes hill home gardens amongst a glass of wine and creation of a social space.

Princes Hill Restorative Garden

The Present

- New communities have moved into Princes Hill and new members of affluent background are moving in.
- Real estate prices are rising due to the proximity to parks and the city.
- This change has brought different communities together in one geography.
- The old and the new have an opportunity to merge together creating and greater community cohesion, cultural respect and inclusivity in Princes Hill.
- Young families moving in and living in the many new apartments with limited space to engage in out door activities.
- Gallagher reserve is a biodiversity harbor/corridor in the area
- The Bocce courts are being used sporadically due to this change.

Princes Hill Restorative Garden

The Future

- Re-birthing the Bocce courts as a forest garden Bocce area, where natural systems and man made systems can coexist.
- Restoration of land around Bocce courts as a bio-diversity harbor where butterfly feeding plants, bird roosting areas can be created to enhance the reserve.
- Create a seed saving network that provides heirloom seeds to community members and stores and records Princes hill heirlooms from the numerous cultures that reside within it.
- Store house of social/ethnic memory such as how to use herbs/spices and vegetables we grow together in our gardens and sustainable urban agriculture technology.
- Create site which is a conversation about what it is to be a modern sustainable Yarra resident.



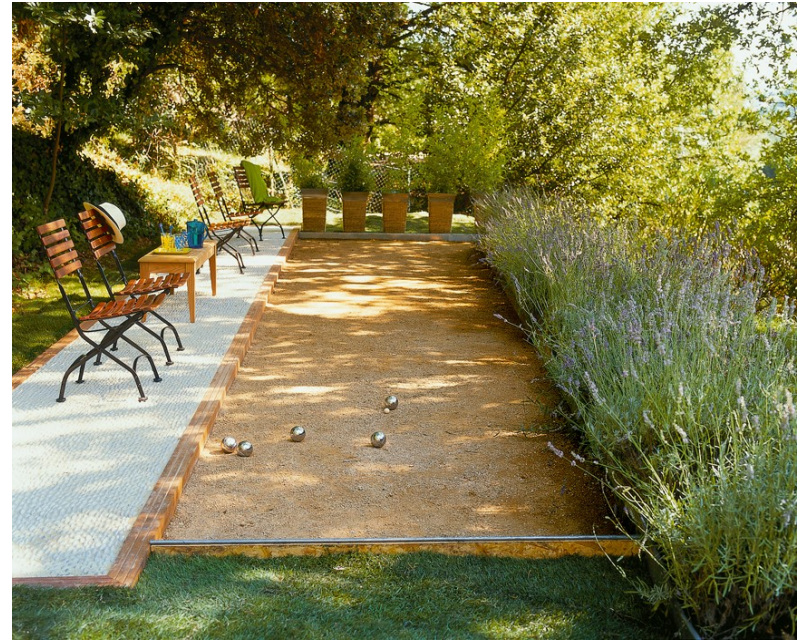

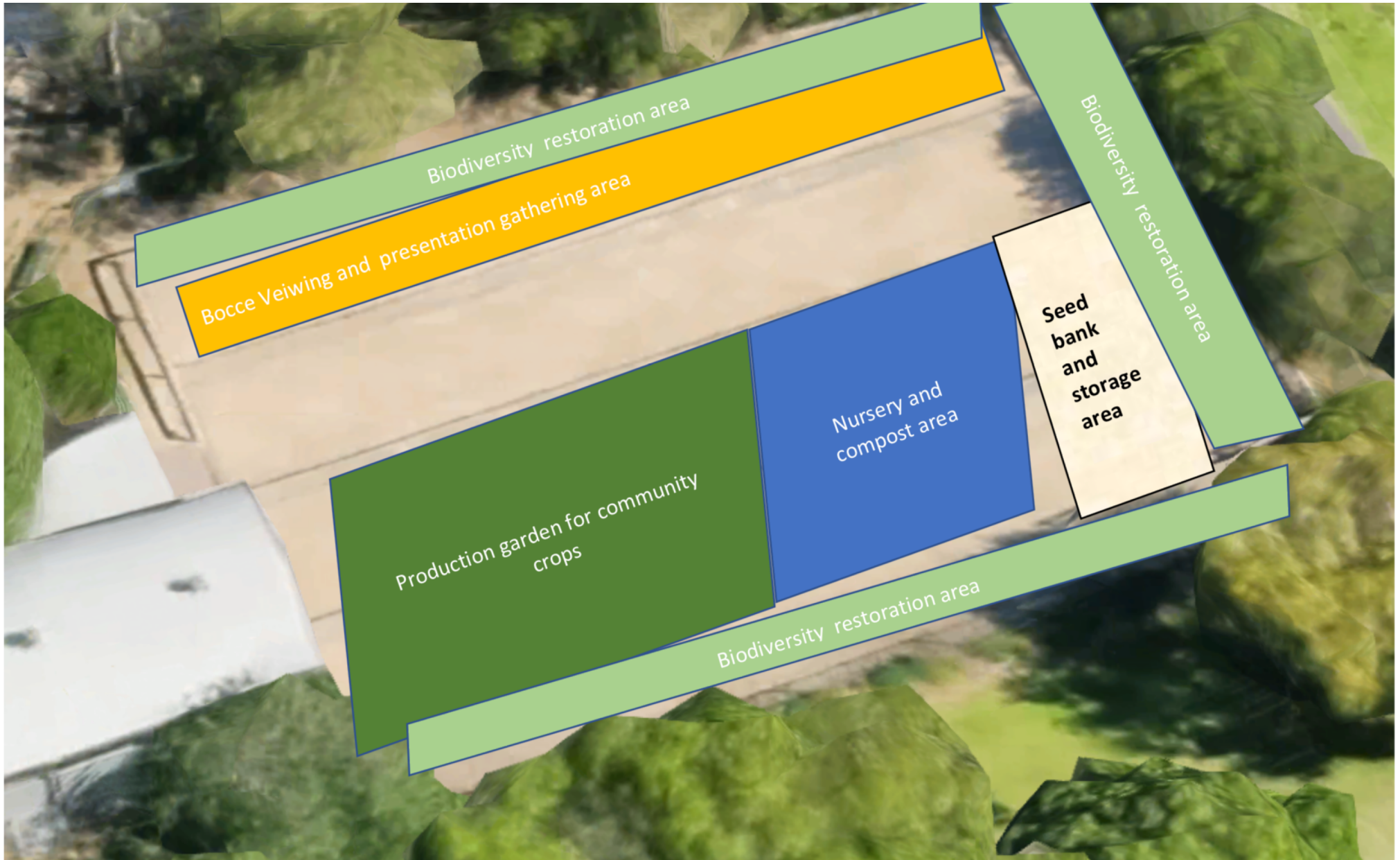

From: [Hanrahan, Justin](#)
To: [Lindsay, Carrie](#); [O'Byrne, Fiona](#)
Subject: FW: Hardy Gallagher Reserve BOCCE COURT CONSULTATION, PRINCES HILL
Date: Monday, 30 April 2018 8:40:37 AM

FYI

From: Fristacky, Jackie Cr
Sent: Sunday, 29 April 2018 8:56 PM
To: Hanrahan, Justin
Cc: [REDACTED]
Subject: FW: Hardy Gallagher Reserve BOCCE COURT CONSULTATION, PRINCES HILL

Hi Justin,

Can you accept the email of 28 April from [REDACTED] as a late submission on the consultation process for use of the Bocce Courts.

Thanks

Jackie

Cr Jackie Fristacky
Councillor for Nicholls Ward, City of Yarra

jackie.fristacky@yarracity.vic.gov.au

Phone 0412 597 794

Small daily improvements are the key to staggering long-term results!

Those who aim at nothing achieve it with amazing accuracy!

From: [REDACTED]
Sent: Sunday, 29 April 2018 10:41 AM
To: Fristacky, Jackie Cr <Jackie.Fristacky@yarracity.vic.gov.au>
Subject: RE: Hardy Gallagher Reserve BOCCE COURT CONSULTATION, PRINCES HILL

Hi Jackie

Happy for you to send my email to the Officer concerned.

Cheers

[REDACTED]

From: Fristacky, Jackie Cr <Jackie.Fristacky@yarracity.vic.gov.au>
Sent: Saturday, 28 April 2018 10:01 PM
To: [REDACTED]
Subject: Re: Hardy Gallagher Reserve BOCCE COURT CONSULTATION, PRINCES HILL

Hi [REDACTED],

Fair comment.

Do you want me to forward your email to the Officer examining & assessing the input from the consultation process?

Jackie

Cr Jackie Fristacky

Sent from my iPhone

On 28 Apr 2018, at 1:27 pm, [REDACTED] wrote:

Hi Jackie

Yes unfortunately the clear indication of the VCAL flyer was that they were raising funds to "build a community garden at the railway house" and it was this that caused a lot of angst among residents of Princes Hill.

I suspect not much can be done about that now.

You are correct that the work of the VCAL students around the Railway House is to be applauded, however there is a huge leap from that work to removing the bocce courts for a community garden.

Probably there is not enough space at the secondary college to have a worthwhile community garden for the VCAL students, however, it might be possible for the PH primary school to find some space on their grounds for a combined garden with the secondary college, a project that both schools could benefit from.

I'm still of the view that removing the fence and the sign that indicates the bocce courts are for hire might well increase usage of the courts. Our group of boule players used the courts last Sunday and several people approached us to find out about hiring the courts, none of them were aware that the courts could be used without a fee and that it was only if the pavilion was used that a hire fee applied. I'm guessing that if a fence were erected around the children's playground with a sign saying "playground for hire" it would end up getting as little use as the bocce courts.

Cheers

A black rectangular redaction box covering the signature of the sender.

From: [REDACTED]
To: [Councillors - Melba Ward](#)
Subject: Hardy Gallagher Reserve
Date: Tuesday, 20 March 2018 4:57:00 PM

On Saturday I attended a brief meeting at the “Bocce Pavilion” at the Railway House Community Centre to discuss plans for the Bocce Courts in Hardy Gallagher Reserve. There are some issues of concern:

General concerns:

- As Council knows there was a bitter dispute which severely divided the Princes Hill community when a garden group sought to acquire a portion of Hardy Gallagher Reserve to grow vegetables. These community divisions had almost healed and I’m disappointed that the Council has reopened these wounds by again encouraging the thought that part of Hardy Gallagher Reserve might be available for this purpose. A large number of rate payers are opposed to using parkland for vegetable production particularly in an area like Princes Hill where many of those wishing to grow vegetables have large blocks of land where they can do so.
- The Council previously voted to not have a vegetable garden in Hardy Gallagher Reserve and noted that there was no suitable unused land in Princes Hill available for that purpose. As a result residents were given the opportunity to acquire planter boxes from Council to be placed on pavements - several have done this.
- The lack of use of the Bocce courts has given rise to consideration of the future use of this area, rather, there should be a consideration as to why the courts aren’t being used. The fence around the courts and sign indicating that the area needs to be hired would be discouraging use.

The Meeting:

- As this is an issue that concerns rate payers I would have thought it relevant to ensure those at the meeting were in fact rate payers of The City of Yarra.
- A number of suggestions had been written on posted notes which were put on the wall of the pavilion and people were encouraged to place stickers on the notes to indicate - supported (green) or not supported (red) – each person having been issued with 4 or 5 green and 2 red stickers. Unfortunately several people adopted the adage of “vote early and vote often” as I saw a number of people who took more than one set of stickers by approaching different council officers assisting. I would suggest that this means that nothing could be read in to the number of stickers, green or red, placed on a given suggestion.

My Suggestion:

- The Bocce courts are clearly an important part of the Italian heritage of the area which I would have thought Council would be keen to retain.
- The fence around the courts gives the sense of an area not open to public use that has to be hired. I’m a member of a group which plays Petanque regularly and when the convener contacted the Railway House Community Centre he was told that the cost was \$200 so we went elsewhere. I have since been informed that it is the pavilion that needs to be hired and not the courts. It is possible to use the courts at no cost but this information was not provided.
- It’s possible that the simple act of removing the fence and sign saying the courts are for hire would indicate to people that this is not a private area but is for public use. This might encourage people to use the courts thus enabling the retention of this heritage area. Bocce and Petanque are played in Europe on any surface, including village squares, or

Yours sincerely

Subject: FW: Hardy Gallagher Reserve Bocce Court

From: [REDACTED]

Sent: Tuesday, 13 March 2018 8:51 PM

To: mbxMayor <mbx.Mayor@yarracity.vic.gov.au>; Councillors - Langridge Ward <LangridgeWardCouncillors@yarracity.vic.gov.au>; Coleman, Misha Cr <Misha.Coleman@yarracity.vic.gov.au>; Councillors - Nicholls Ward <NichollsWardCouncillors@yarracity.vic.gov.au>; Councillors - Melba Ward <MelbaWardCouncillors@yarracity.vic.gov.au>

Subject: Hardy Gallagher Reserve Bocce Court

14-3-2018

Mayor, Deputy Mayor and Yarra City Council Councillors

Hardy Gallagher Reserve

Bocce Court development

Dear Mayor, Deputy Mayor and Councillors,

You may be aware that the bocce courts near the North Carlton Railway House Community Centre are now not used a great deal. The proposal is to use bocce court land in other ways. Ideas have been sought on line and Yarra Officers are going to conduct a workshop on Saturday the 17th March 2018 on the possible future use of the bocce courts. Many of you may be unaware of the historic details concerning the Hardy Gallagher Reserve.

This area was won after a hard battle against developers in the 1960's. Developers wanted this area of land, that was originally Victorian Railways land, as a "Kleenex" warehouse. Fortunately, and due to the efforts of Mr Hardy and Mr Gallagher as well as the community, this did not happen and this reserve has been free open space that is available for everyone to use and enjoy. The Bocce courts were built and well used initially due to the large Italian population nearby. There are few of these original players now. The North Carlton Railway House Community centre is loved and well used.

In around 2010 and 2012 there were moves by a local gardening group to make a so-called "Community Garden" in the Hardy Gallagher Reserve which would involve fencing off sections of the park for the exclusive use of the plot holders. Various locations within Hardy Gallagher Reserve were proposed, including the bocce courts.

There was massive opposition to this proposal, as most people in the neighbourhood considered that the park should remain an open area, free for all to visit and enjoy. After many letters, proposals to council and even a special committee to examine all issues, it was decided by council vote on at least 2 occasions to not have a community garden in the Hardy Gallagher Reserve, or indeed in any other park in the municipality as this would reduce access by the

broader population. The local population has grown even more since then, and parkland is indeed even more precious.

In 2012, assessment of all local land by Yarra Council indicated there was no “spare” unused land for an additional community garden. There is Rushall Gardens, a fenced in community garden, primarily for vegetable growing near Rushall Station, North Fitzroy.

The idea of planter boxes was approved by Yarra Council so that people who wished to, could grow some vegetables in them near their own home.

There was a lot of friction, ill feeling and unhappiness between folks in the Princes Hill neighbourhood during the time of that community garden proposal for Hardy Gallagher Reserve, and I sincerely hope that the Yarra Council and staff remember what happened before and will not let that happen again.

The online proposals now clearly indicate that some people are again proposing a “community garden” as a future use of the bocce courts, probably in the form of raised planter boxes.

If the thinking is that a “community garden” is an unfenced open area, that is unencumbered by clumsy looking planter boxes, and has some flowers and trees in an area open to all, where all people can sit and relax, then I suspect there will be few objections.

The local feeling is that this reserve should remain as free open space that is available for **everyone** to use and enjoy.

I hope you will consider all these factors in the future.

Thank you for your consideration.

Yours sincerely,

[Redacted signature]

[Redacted address line 1]

[Redacted address line 2]

[Redacted address line 3]

[Redacted address line 4]

O'Byrne, Fiona

From: mbxOpenSpace
Subject: FW: Hardy Gallagher Reserve

From: [REDACTED]
Sent: Tuesday, 27 March 2018 2:48 PM
To: City of Yarra Info
Subject: Hardy Gallagher Reserve

Thank you for the opportunity to submit a proposal for the future use of the disused bocce court in Hardy Gallagher Reserve.

While there are several very active petanque clubs in the southern and eastern suburbs, e.g. St Kilda, Camberwell, Caulfield, Doveton, Casey, and on the Mornington Peninsula, e.g. St Andrews Beach, Main Ridge, Portsea, the nearest petanque club north of the Yarra is at Woodend.

I propose that:

1. the bocce court at Hardy Gallagher Reserve is converted to an open, gravelled area suitable for setting up as petanque pistes;
2. the converted area is made available to an established petanque club for a trial period of perhaps twelve months;
3. the club would seek members in the City of Yarra and the inner north of Melbourne;
4. at the end of the trial period, the club would, in consultation with the City of Yarra:
 1. continue the arrangement for a further, specified period; or
 2. facilitate the establishment of a separate North Carlton Petanque Club; or
 3. discontinue its use of the Reserve.

I am a registered member of Smythesdale Petanque Club which is affiliated with the Petanque Federation of Australia. I believe that the Smythesdale club would be a suitable sponsor to establish a northern suburbs playing group on the Reserve.

Players who joined the club would immediately have the opportunity to play in any of the numerous competitions held throughout the State in attractive locations such as Apollo Bay, Avoca and Halls Gap.

On several occasions, I have played social petanque on the open gravel area adjacent to the North Carlton Neighbourhood House and once or twice used the bocce court at the invitation of the people at the Neighbourhood House. I have been made to feel very welcome by the Neighbourhood House and can confirm that they look out onto very nice gravel!

I would welcome the opportunity to discuss this proposal in more detail or to refine it.

--

[REDACTED]

From: [REDACTED]
To: [City of Yarra Info](#)
Subject: Hardy Gallagher Reserve
Date: Thursday, 1 March 2018 5:25:27 PM

Inclusive community garden

From: [REDACTED]
To: [Councillors - Langridge Ward](#); [Councillors - Melba Ward](#); [Councillors - Nicholls Ward](#)
Cc: [REDACTED]
Subject: Fw: Proposed Bocce Court Use in Hardy Gallagher Park
Date: Monday, 19 March 2018 8:46:53 PM

I am a resident of Park Street Brunswick and would like to pass on my thoughts as to the future use of the land currently taken up by the bocce courts, as I was unable to attend the workshop meeting due to prior commitments.

Hardy Gallagher Reserve is a precious valued small piece of open parkland giving us a slice of heaven, available to all young and old, offering a respite from the noisy, overcrowded, densely populated, neighbourhood we now live in. The tremendous growth in high rise development (including the proposed 300 unit Park St complex) only highlights the importance of protecting open space, already in such short supply in the inner suburbs for use by the broad population, including the aged.

In the 70's the Community fought hard to win this parkland, so it could be used by all. In around 2010 and 2012 there were moves by a local gardening group to use the Bocce Courts for their own purposes. These proposals caused a lot of ill feeling in the community. The proposals were rejected by the council who approved the idea of planter boxes on pavements and lanes so that people could grow plants or vegetables in them.

Now that the bocce courts are no longer used, I believe the land should revert to open parkland, for use by the general community including the aged. We do have an ageing population and they are an important part of the community. Once you fill up this space currently occupied by the courts with any sort of furniture or structure (boxes etc.) it excludes that area from use by the majority of the community. The courts take up a small but very significant area in terms of available open space and the amount of planter boxes would be limited. Using laneways and pavements would increase the capacity many fold and allow more community participation. The distribution of planter boxes over a wide area would also reduce the likelihood of rodent and other infestations, associated with community gardens, so close to houses and a school.

The residents of Park St already pay a high price in terms of loss of amenity associated with the Neighbourhood House. We are subjected to noise seven days and nights a week, from functions and activities inside and out, (parties, kids parties, weddings, band practice, choirs etc) as well as traffic congestion and noise on arrival and departure of attendees as well as a loss of very limited street parking.

The outdoor seating, specifically installed for the Neighbourhood House is now used for congregation and drinking of alcohol until the early hours of the morning making it very difficult to fall sleep. There were no problems before these were installed. Then we get awoken yet again by the sound of bottles smashing as the garbo's empty the bins, any time between 2am and 4am. The Neighbourhood House is a great resource, but some of us do pay a high price, it

seems.

We just want things as peaceful and quiet as possible, an extra bit of precious open parkland which everyone young and old can enjoy and admire, nothing else.





North Carlton Railway Neighbourhood House
PO Box 1
North Carlton 3054

Ph: 9380 6654

SUBMISSION FROM RAILWAY NEIGHBOURHOOD HOUSE TO CITY OF YARRA'S CONSULTATION ON THE BOCCE COURT SITE, GALLAGHER RESERVE

PURPOSE

The Railway House Committee of Management seeks to convert the disused bocce site into a well designed neighborhood garden.¹The design may include other compatible recreational amenities. This would be a creative and socially inclusive project and a significant opportunity for the Railway House to generate social, environmental and economic benefits to its community.

BACKGROUND TO THE CONSULTATION ON FUTURE USE OF THE BOCCE COURT SITE

In 2015 Railway House undertook a consultation with current users and, in view of the positive response, approached Yarra Council at the end of 2015. After two further meetings during 2016 it was agreed at a meeting in 2017, convened by Cr Jackie Fristacky, that Open Spaces would undertake a local consultation about possible future uses of the bocce court site.²The consultation period began in late February, 2018.

COMMUNITY GARDEN HISTORY ON HARDY GALLAGHER RESERVE

The current proposed model of a neighborhood garden avoids all previous objections raised during a past attempt to establish a community garden in Princes Hill.³ It is not encroaching on public parkland but simply using land already fenced for a different purpose. The model for this garden would be of a shared garden, with no individual plots and open to the public.

¹The Bocce Club formally wound up several years ago. Since that time the Railway House Committee of Management's Chair initiated regular bocce games with lunch, with prominent notices on the fence, and promoted it to hirers of the House. However, little interest has been shown. Although Council maintains the bocce court surface it has a derelict air, requiring new surfacing and frequent maintenance, which Railway House does not have the capacity to provide. It is currently used occasionally as an informal dog park by day, and at night it attracts vandals and drug users.

²It was made clear that the consultation would be open-ended rather than specifically about the Railway House's request to repurpose the area as a garden.

³Approximately ten years ago Council attempted to initiate a community garden on the Hardy Gallagher Reserve with a group of local gardeners invited to incorporate and run the garden. This initiative inspired a great deal of opposition. The main stated objections to the garden were that it was alienating parklands; that it would be comprised of private plots; that it would be closed to the general public; that it would attract vermin; that it would have a 2m high surrounding fence; that it would look unattractive. The spread of misinformation was problematic and framed the debate negatively. Nonetheless, these were the main identified issues that concerned local residents at the time and they deserve proper consideration today.

WHY THE RAILWAY HOUSE IS AN IDEAL AUSPICE FOR A GARDEN

The Railway House is a relatively small neighborhood house with 2 EFT staff and 3 rooms. The limitations of the building make expansion difficult. However, it is set in beautiful parkland and is on the bike track. The addition of the bocce court as an outdoor neighborhood house space would allow for expansion of the work of the House. It could, for example, provide an excellent outdoor teaching space for children. It is expected that a garden would expand the demographics of the House users, as well as improve the amenity for current users. To actively garden, people would be required to become members of the Neighbourhood House. This would provide a code of conduct, insurance and agreement on a set of gardening rules consistent with safety & organic gardening practices. Access, however, would be open to the public at all times for enjoyment of the space.

CONFORMITY WITH COUNCIL POLICIES

This proposal is in line with and will help to implement Council's policies on Sustainability and Urban Agriculture. Neighborhood Gardens are about far more than agriculture and growing. They are about community building, bringing together people from all classes, ages, educational and cultural backgrounds to share in the joy of gardening. They are also about educating young people about gardening in small spaces in times of increasing urbanization and alienation from the natural world. Gardens encourage connection through skill sharing and develop awareness of environmental and sustainability issues at a local level. Council's recent concerns about waste management indicated the need for greater community ownership and awareness of issues relating to sustainable living.

THE NEED FOR SMALL LOCAL GARDENS AS URBAN DENSITY INCREASES

Council has a policy of actively creating green spaces as urban density increases. Here we have an abundance of green space. This land abuts Moreland where 4 blocks of flats of over seven stories have been/are being built at the junction of Lygon St. and Brunswick Rd. and a further block is being planned at the corner of Park St. and Sydney Rd. A visit by one of our committee to the 1 Lygon St flats has indicated there are a number of young residents who are very interested in gardening, with many stating that they do not know anyone in their building. As urban density increases the need, not just for green spaces but for active gardening opportunities, will increase. Parks are not created for passive leisure alone, but for the public to use the spaces for active pursuits that connect to community and act as an effective 'third space'.⁴

THE HOUSE FABRIC – ECONOMICS OF A GARDEN

The creation of a garden adjacent to Railway House would allow for additional training opportunities to be offered. Some of these programs would attract training funding & offer pathways to further study or employment. Furthermore, such programs would help fund the garden, ensuring that both the garden and the area around the Railway House are well maintained.

Conversion of the bocce court to a garden need not be a costly operation. A comparable garden at University College at the University of Melbourne cost \$50,000 to establish. However, this included fencing, which would not be required on this site.

The site currently has:

- A lockable garden shed to store tools
- Toilets and taps
- A building with a roof suitable for tanks to harvest water

⁴<https://theconversation.cmail19.com/t/r-l-jywdka-iyjlhklklu-a/>

'In third places, people are free to come and go without obligation. The status and backgrounds of users are largely irrelevant. These places are generally designed to be accessible, accommodating and inviting for all ages, low-profile, comfortable and conversational...Third places can lead to more resilient and better-connected communities, building up social capital, while reducing loneliness.'

- It is fully fenced
- It has a flat gravel surface
- A pavilion with doors opening onto the site which would be very suitable indoor/outdoor classroom
- Kitchen facilities (in above room) adjacent to the site.

LOCAL VOLUNTEER SUPPORT – THE TRACK RECORD

A group of between 8 and 14 volunteers has been intensively involved with looking after a garden alongside this site for the past three years. They meet monthly and also have twice-yearly working bees.

They have:

- Maintained the cottage garden alongside the bocce court
- Refurbished the derelict gardens at the front of the Railway House
- Created a small native garden at the back of the House near the Pavilion.

This has been done almost entirely with plants and materials supplied by the volunteers.

In 2018 The Princes Hill Secondary College VCAL Program developed student led activities at the Neighbourhood House. Students have:

- Participated in gardening activities
- Made and hosted a community lunch
- Initiated a composting project as part of a Sustainability program for the School and the Neighborhood House
- Delivered flyers
- Participated in meetings& written submissions to Council

The gardening groups from Railway House and Princes Hill Community Centre, along with Bunnings staff, collaborated with residents of the Housing Estate in 2017 to jointly build their vegetable garden.

The proposed garden will attract new volunteers and membership to the Railway House.

FINANCIAL SUPPORT FROM OUTSIDE COUNCIL

Bunnings of Brunswick have already supplied a range of tools to the railway House Gardeners group, but have indicated a willingness to do more.

The Railway House itself has given very minimal financial support at this stage, given the uncertainty surrounding future usage of the bocce site.

Once established there is not a great cost involved in maintenance of a garden given the use of volunteer labour instead of Council resources.

Thank you for the opportunity to submit our proposal.



Committee of Management, Railway Neighbourhood House

26 March, 2018

From: [REDACTED]
To: [City of Yarra Info](#)
Subject: Att. Bruce Phillips
Date: Friday, 16 March 2018 7:26:55 PM

Bruce Phillips
Director, Planning and Space Making
City of Yarra.

Dear Bruce,

I would like to add my voice to those who are supporting the proposal for a neighbourhood garden to be established for the Neighbourhood House, Old railway Station at Carlton North, I understand the disused Bocce bowls area is being considered for such a purpose.

This would not only enhance the appearance of the area but be serving a practical role in provision of vegetables for meals at the Neighbourhood House. I have lived in Carlton North for 48 years and am well informed of the history of the precinct and would welcome such a scheme.

Yours Sincerely,

[REDACTED]
[REDACTED]

From: [REDACTED]
To: [City of Yarra Info](#)
Subject: Hardy Gallagher Reserve
Date: Friday, 2 March 2018 12:38:40 PM

garden of contemplation

Garden of reflection - put this one in for my 86 yr old neighbour who is now in a nursing home.

[REDACTED]

Sent from my iPad

From: [REDACTED]
To: [City of Yarra Info](#)
Subject: Hardy Gallagher Reserve
Date: Thursday, 8 March 2018 11:48:37 AM

Hi, i had 3 goes at the online system but it wouldnt complete. Too hard, so I am emailing instead.

I use the Park St walking track most days at different times of day and I live at Wilson St part time. Having looked at HGR regularly and knowing what is available at the Princes Park area it seems to me that the most lovely thing for HGR would be to complement the neighbourhood centre by providing a well designed area w at least

- 2 or 3 concrete table tennis tables like they do in sydney, new york and paris. People bring their own bats and balls.
- an outdoor chess table set like Hyde Park in Sydney
- some gym stretch and flex equipment like at Bondi beach

The area should be active and also allow for passive sitting to watch the activities.

The HGR is next to housing commission with many people wanting to be active and social near by. Their is also the Redmond House aged care building near by with an older population wanting to engage in some activity. The primary school opposite allows for basketball and young kids to ride bikes etc but there is nothing for the older group or people who use the bike path to stop and do some gym stretches.

When I was researching open space in copenhagen, amsterdam and paris I observed the best ones had a combination of active and passive uses so that they attracted all age groups with the very old sitting watching the activities while they chatted to friends. Princes Hill and Princes Park cater well for young and very active mobile but do nothing for the more gentle but engaging activities required by adolescents and older groups to coexist.

This area does feel very neglected and in need of regeneration so it is good you are thinking of it. I know there was a move a while ago to turn it into community garden but residents objected. Maybe herb boxes could be planted in between new uses so that a broader audience and locals could benefit.

The young kids equipment to the west of the neighbourhood centre also needs a sail cloth or something for shade protection.

One of the biggest barriers to that end of Wilson Street is the unsavoury and huge pile of rubbish, shopping trolleys etc that always seems to be outside the housing commission. Maybe council could work with the housing office and supermarkets to improve this situation.

I will be away on 17 March so wanted to submit this now.

Regards
[REDACTED]

From: [REDACTED]
To: [City of Yarra Info](#)
Subject: Hardy Gallagher Reserve
Date: Monday, 12 March 2018 5:38:30 PM

I am a resident of Princes Hill and am wholly supportive of a community garden at the disused bocce court. The site is next to the neighbourhood house and would be a wonderful asset for the community providing an opportunity to learn about growing food in small,urban spaces.

[REDACTED]

Sent from my iPad

FACILITATOR SUMMARY | KEY STAKEHOLDER WORKSHOP

North Carlton Bocce Courts Engagement

Facilitator: Jessica Christiansen-Franks (CEO, Neighbourlytics)

April 2018

OVERVIEW

On Thursday 18th April 2018, City of Yarra hosted a meeting with key stakeholders to discuss the future use of the North Carlton Bocce Courts, as part of a broader program of engagement with the local community. The session was structured to directly build upon feedback received via Your Say Yarra's online forum, and the public drop-in session held on site in March 2018.

The main objectives of the event were to provide key stakeholders and community representatives the opportunity to:

- Reflect on the outcomes of previous engagement activities
- Discuss key objectives for the space, as they relate to the organisations they represent.
- Hear from other stakeholders about the (perceived or actual) challenges or concerns relating to different uses.
- Find areas of consensus between one another.

This document intends to provide a summary of the evening as recounted by the facilitator.

THE PROGRAM

Part 1 | INTRODUCTIONS & KEY TOPICS TO COVER

At the commencement of the session participants were asked to introduce themselves, and each outline a key topic they wanted to ensure the meeting covered. The key topics are outlined below as presented by the group.

- Planter bed accessibility
- Noise or other things that distract from local amenity
- Community building is important
 - Shared garden would connect local people
- Any community garden would need to consider:
 - Climate change
 - Social isolation
- Quiet seating space very important- bike activity can be hectic
- An educational space to cater to all ages
- Space should further enhance Neighbourhood House facilities and potentially bring in income
- Maintenance of space as 'public' is very important- community gardens should not take up space which is currently public
- Space should be attractive, lots of seating and usable space
- Think if different food growing models
- Space should be usable by all, meaning the fence should be removed
- Heritage of site, where bocce is relevant to cultural past.

Parts 2 & 3 | MAIN DISCUSSION

As representatives of key groups within the local community, the participants were asked to reflect on the top 5 themes that appeared across the engagement process, and discuss the challenges and potential solutions for each. A summary of this discussion is represented as follows:

	Consideration & Challenges	Solutions
General	<ul style="list-style-type: none"> • Vandalism is concern • Respect heritage of the site • Drug users might hang out in a new space 	<ul style="list-style-type: none"> • Space becoming an asset for the Neighbourhood House • A mix of uses could accommodate everyone's priorities
Productive Garden	<ul style="list-style-type: none"> • Public space should not be taken for private use, and community gardens are exclusive • Who is entitled to take the produce/has access to the boxes? • Who maintains the garden year-round? • Gardening only appeals to select few, and is not inclusive for all • Produce will be eaten by rats and possums • Garden should be high quality design to improve amenity of the neighbourhood. • Waste disposal of productive garden can be a problem 	<ul style="list-style-type: none"> • Must be inclusive, with open access for anyone to enjoy • Not an "allotment" style community garden • Garden open to all people • City of Yarra would maintain the garden, with assistance from Neighbourhood House for community access • Should be mix between productive garden and display garden (ie; French) • Involve school kids in programs • "Harvest Feast" as a way of getting together • Regular working bees • Excess produce should be given to food bank • Connect to VCAL program • Low maintenance plants (ie; fruit trees and herbs)
Bocce Courts	<ul style="list-style-type: none"> • There are other bocce courts in the area, so these ones are not needed • Needs a new surface, this can be time consuming to maintain • Bocce is only of interest to a small proportion of people 	<ul style="list-style-type: none"> • Bocce courts reflect the local heritage of local area • Keeping one lane open would allow other uses to also take place • ½ bocce courts and ½ passive seating would work • Fence must be removed to make accessible
Native Parkland	<ul style="list-style-type: none"> • Should be well maintained and look better than current natural reserves in the are/ • There is enough native parkland 	<ul style="list-style-type: none"> • Refurbish existing native parkland before adding more • Native corridors are important

	already	• Bird life is important, and tree create bridges
Children's Playspace	• There are enough children's playspaces already, including one adjacent to the Neighbourhood House.	• Childrens play or education elements can be inciorporated into community garden

FACILITATOR OBSERVATIONS & COMMENTS

The following is the facilitator's summary of the key points of agreement reached by the participants. Note that this is intended as a distillation of the discussion held on the night, and has not been provided to the participants for comment.

- All participants agreed that the space needed to be inclusive, and function as a key gathering space for the community. Despite this shared aspiration, the attendees had differing views about the best use to achieve this.
- The conversation was dominated by discussion about a productive community garden in the space. Discussion about use of the bocce courts was the second most popular topic.
- Some supporters of the community garden noted that this use should primarily be maintained and managed by the City of Yarra. Due to time constraints this topic was not able to be further explored and it is recommended that more direct consultation is undertaken should a community garden be pursued.

Shared views

- Social inclusion and isolation is very important to the community.
- The space should function as part of the cluster of community uses around the Neighbourhood House.
- The space should be for the community, accessible by all.
- A mix of uses may help the space appeal to everyone.
- Vegetation selection should be low maintenance to ensure the space looks tidy and discourage vandalism. Productive plants such as fruit trees and herbs may also conserve space and allow more areas for seating and socialising.
- Space should be high quality, and enhance the amenity of the local area. The design and maintenance of the space were identified as key considerations here.
- Allowing the space to be programmed with activities and events is important.
- Noise generating uses are not appropriate, especially active sports like basketball.

Differing views

- The use of space as community garden. All participants appeared to agree that an 'allotment' style community garden was not appropriate, but there was much discussion about what other form this might take.
- Retention of the bocce courts. Some people felt they were current not used and should not be retained, while others felt they were an important part of the site's heritage, and regular maintenance would encourage use.

Attachment 6: Proposed lease area



Lease area to extend 1m on southern side of bocce courts to encompass existing strip of garden bed currently being maintained by North Carlton Railway Station Neighbourhood House Committee of Management.